

Notes:

1. This is a performance drawing which should be used for guidance and pricing only.
2. Construction/working drawings are the sole responsibility of the contractor.
3. Do not scale from this drawing use figured dimensions only.
4. This drawing to be read in conjunction with the relevant sections of the specification, schedules, architects drawings and structural engineers drawings.
5. The consulting engineer shall be notified by the contractor of any errors and omissions.
6. Exact location of all plant equipment and penetrations are the responsibility of the contractor who shall co-ordinate the installation with other trades.
7. The contractor shall note that all pipework and ductwork routes are indicative only.
8. This drawing is intended to be viewed in colour.
9. Existing network lines are shown in orange. Specific network lines are as noted.
10. Co-ordination between services are to be carried out onsite. Surveys of existing and proposed locations of routes shall be carried out prior to works.

Symbols Reference:

- - - Existing line (As Noted).
- - - ESB line.
- TELECOM - 4no. 110mm Universal Comms ducts.
- GAS line.
- WM - Water main.
- ☒ Access Chamber.
- ◻ Existing FWAA Access Chamber.
- ◻ New FWAA Access Chamber.

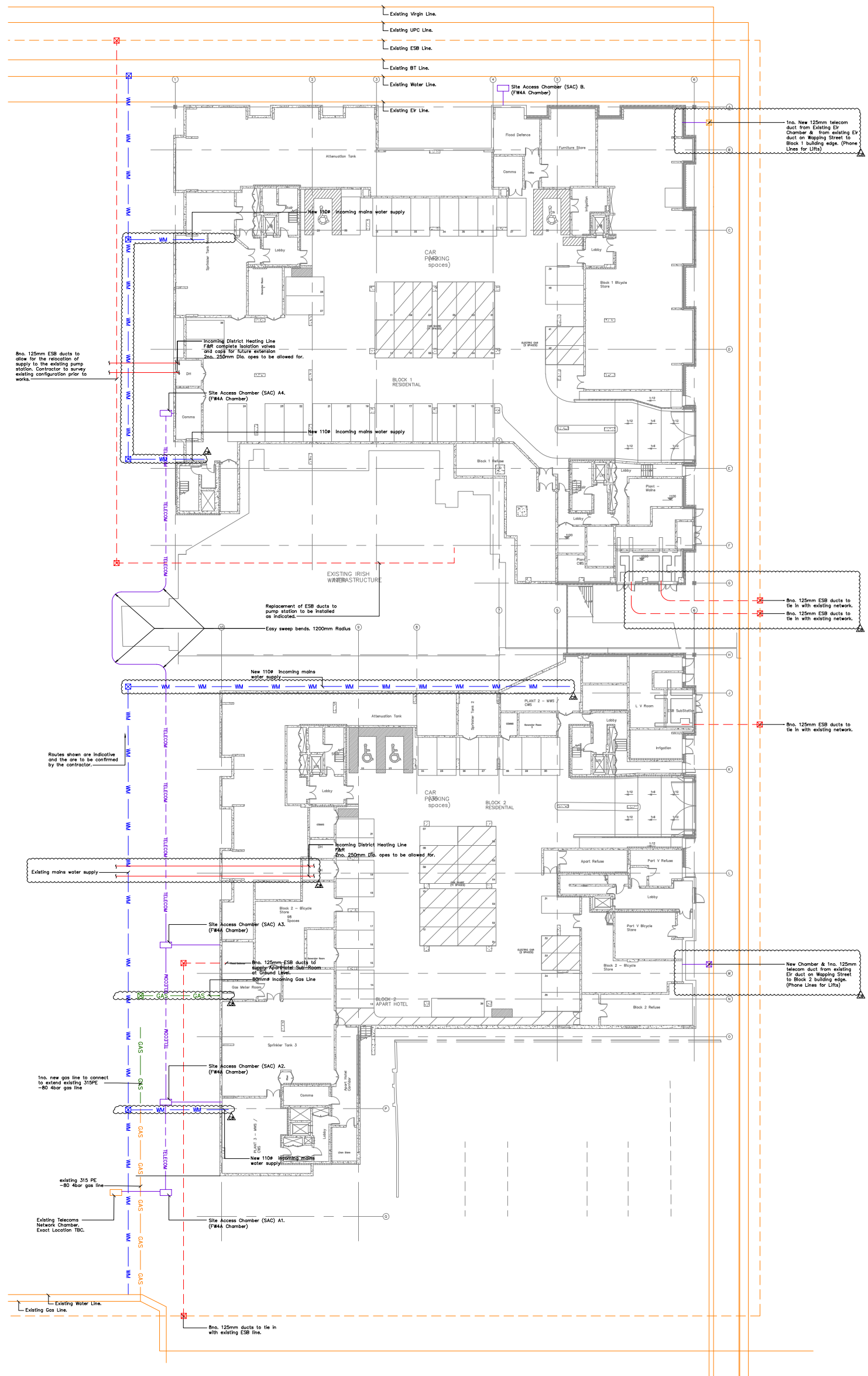

CD7	10.06.19	CONTRACT ISSUE	SS	CJ
CD7	28.03.19	CONTRACT ISSUE	SS	CJ
CD6	25.02.19	CONTRACT ISSUE	RW	KW
CD6	10.12.18	CONTRACT ISSUE	SS	CJ
CD5	25.11.18	CONTRACT ISSUE	RW	KW
CD5	14.09.18	CONTRACT ISSUE	RW	KW
CD2	06.09.18	CONTRACT ISSUE	EH	CJ
CD1	05.09.18	CONTRACT ISSUE	EH	CJ
REV	DATE	AMENDMENT	DRN	CHK

CONTRACT ISSUE

axiseng
consulting engineers

Client: Roman Group Real Estate
Architect: Henry J Lyons

Project: Spencer Place North - Additional Floors
Site Plan
Site Services Layout

Dwg. No: SPK3-AE-ZZ-DR-E-60101
Job No: 18026 - 3 Floors
Scale: 1:200 @ A0

Status: **D3**
Revision: **C08**

This drawing is the property of axiseng. Copyright is reserved for axiseng and the drawing shall not be copied, reproduced or otherwise used without the consent of axiseng.